

Cromwells
Estate Agents

Gomshall Avenue, Wallington, Surrey, SM6 8NY
Asking Price: £520,000

A well presented and extended three bedroom terraced property, Providing excellent potential for further extension (STPP). The property is in a sought after location, close to local schools, shops and transport links.



***Two good size reception rooms *Detached garage
*South-west facing rear garden *Driveway for off
road parking**

Entrance Hallway

Storage cupboard under the stairs. Doors leading to:

Reception room - 14' 10" x 12' 0" (4.52m x 3.65m)

Front aspect bay window

Dining Room - 13' 9" x 9' 10" (4.19m x 2.99m)

Door leading to the conservatory and opening into the kitchen

Kitchen - 9' 4" x 8' 0" (2.84m x 2.44m)

Door leading to the covered area

Conservatory - 10' 2" x 6' 1" (3.10m x 1.85m)

Sliding door leading into the garden

Covered area

First Floor Landing

Leading to:

Bedroom 1 - 15' 9" x 10' 8" (4.80m x 3.25m)

Front aspect bay window, built-in wardrobes

Bedroom 2 - 13' 5" x 10' 0" (4.09m x 3.05m)

Rear aspect, built-in wardrobes

Bedroom 3 - 8' 0" x 7' 3" (2.44m x 2.21m)

Front aspect, bay window

Separate WC

Bathroom

Rear aspect, storage cupboard

Outside

Detached garage



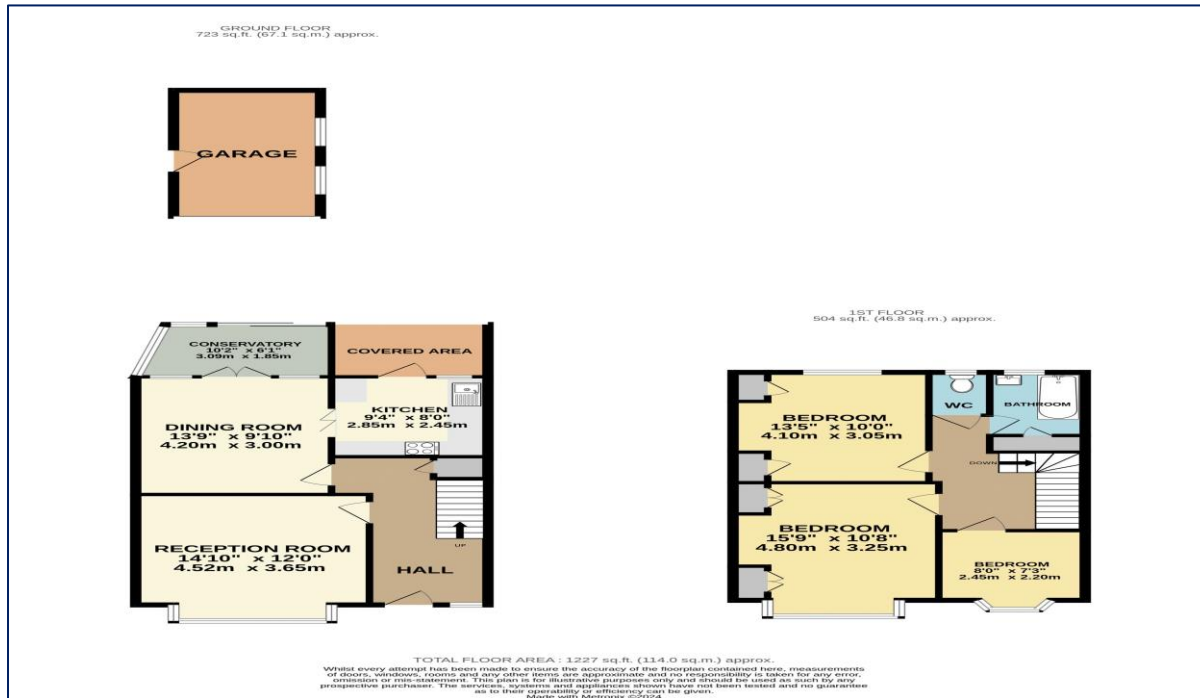

Council Tax - G Local Authority: London Borough of Sutton Tenure - Freehold



95 Banstead Road
Carshalton
Surrey
SM5 3NP



020 8642 5468



admin@cromwellscarshalton.com



www.cromwellsestateagents.uk

Score	Energy rating	Current	Potential
92+	A		
81-91	B		87 B
69-80	C		
55-68	D	68 D	
39-54	E		
21-38	F		
1-20	G		



Disclaimer

These particulars are not an offer or contract, nor part of one. You should not rely on statements made by Cromwells in the particulars or by word of mouth or in writing ("information") as being factually accurate about the property, its condition or value. Neither Cromwells nor any joint agent has authority to make representations about the property, and accordingly any information given is entirely without responsibility on the part of the agents, seller(s) or lessor(s). Photographs show only certain parts of the property as they appeared at the time they were taken. Areas, measurements and distances are given as an approximate only. Any reference to alterations to or use of, any part of the property does not mean that any necessary planning, building regulations or other consents have been obtained